

FULL ROUND

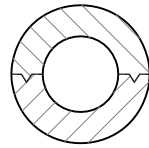

SPLIT ROUND

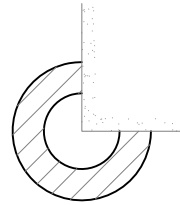

THREE-QUARTER ROUND

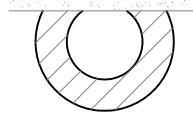

PARTIAL ROUND

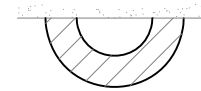

HALF ROUND

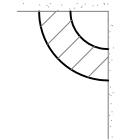

QUARTER ROUND

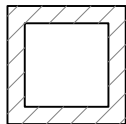

FULL SQUARE

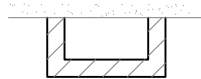

HALF SQUARE

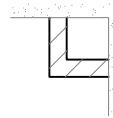

QUARTER SQUARE

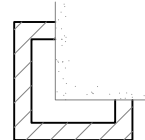

THREE-QUARTER SQUARE

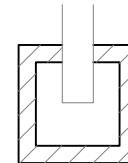

NOTCHED SQUARE

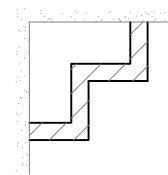

CUSTOM QUARTER SQUARE

ALL RIGHTS RESERVED. THIS DRAWING IS PROPERTY OF STROMBERG ARCHITECTURAL PRODUCTS INC. AND MAY BE USED ONLY WHEN UTILIZING STROMBERG ARCHITECTURAL PRODUCTS. STROMBERG ARCHITECTURAL PRODUCTS INC. GENERAL TERMS AND CONDITIONS APPLY AND ARE INCORPORATE HERE IN BY REFERENCE. THIS DETAIL MAY NOT APPLY TO ALL CONDITIONS AND CONSTRUCTION SITUATIONS.



STROMBERG ARCHITECTURAL PRODUCTS INC.

4400 Oneal Street, Greenville, TX 75401 Phone 903.454.0904 Fax 903.454.3642

TITLE: COLUMN TYPES

SCALE: NTS

TYPE DWG: PICTORIAL

DWG. SHEET: SAC-104